

Speaker Sound Generators - Receiver

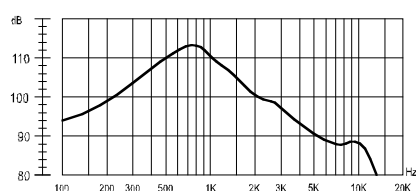

Frequency Response

Applied Voltage : 179mV, Sine Wave
Based on IEC-R318 Standard



HSR13P

Dimension Unit:mm Tolerance:0.3mm

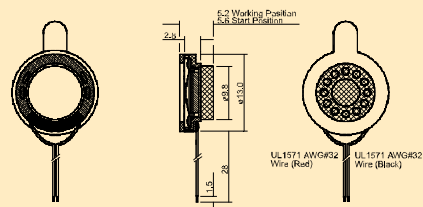

Specification (all data taken at 25°C unless otherwise specified)

Model	Coil Impedance (Ω)	Rated Power (mW)	Maximum Input Power (mW)	★Sensitivity at 1kHz (dB)	★Frequency Range (Hz)	Total Harmonic Distortion (THD)	Operating Temperature (°C)	Storage Temperature (°C)
HSR13P-32	32 ± 15%	5	10	111 ± 3	100 ~ 5000	<3%	-20 ~ +60	-40 ~ +80

The specifications are only for 32Ω version. Specification for other impedance is available upon request.
★ Value Applied 179mV Input Power and Based on IEC-R318 Standard.

HSR13Q

Dimension Unit:mm Tolerance:0.3mm

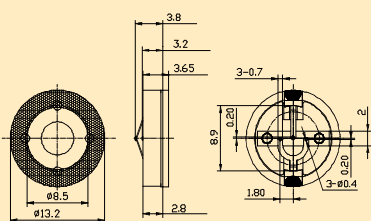

Frequency Response

Applied Voltage : 100mV, Sine Wave
Based on IEC-R318 Standard

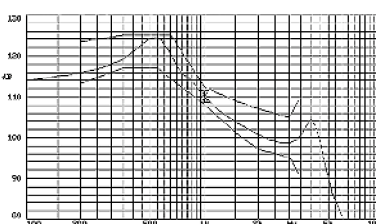

Specification (all data taken at 25°C unless otherwise specified)

Model	Coil Impedance (Ω)	Rated Power (mW)	Maximum Input Power (mW)	★Sensitivity at 1kHz (dB)	★Frequency Range (Hz)	Total Harmonic Distortion (THD)	Operating Temperature (°C)	Storage Temperature (°C)
HSR13Q-32	32 ± 10%	10	30	110 ± 2	300 ~ 3400	<5%	-40 ~ +70	-40 ~ +85

The specifications are only for 32Ω version. Specification for other impedance is available upon request.
★ Value Applied 100mV Input Power and Based on IEC-R318 Standard.



Frequency Response

Applied Voltage : 179mV, Sine Wave
Based on IEC-R318 Standard

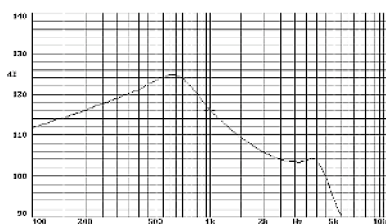

HSR1420A

Dimension Unit:mm Tolerance:0.3mm

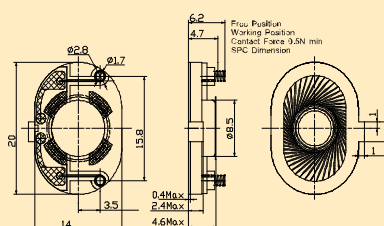

Specification (all data taken at 25°C unless otherwise specified)

Model	Coil Impedance (Ω)	Rated Power (mW)	Maximum Input Power (mW)	★Sensitivity at 1kHz (dB)	★Frequency Range (Hz)	Total Harmonic Distortion (THD)	Operating Temperature (°C)	Storage Temperature (°C)
HSR1420A-32	32 ± 10%	10	20	116 ± 3	300 ~ 3400	<5%	-40 ~ +80	-40 ~ +80

The specifications are only for 32Ω version. Specification for other impedance is available upon request.
★ Value Applied 1mW Input Power And Based On IEC-R318 Standard.